



Data Sheet  
High Performance Door  
**RapidRoll® 660**

The specialist for the most difficult applications

Whatever your requirements, this door continuously masters even the most severe and rugged conditions.

One of our best sellers, including the RollTex® curtain and a combined counterbalance and curtain tension system for extraordinary wind stability. Additional moving wind bar also available.

Frequency converter control system ACS 70 as standard.

SRD - self repairing knock-out capability as option for sizes up to 5.5 x 5.5 m  
(max. 22 m<sup>2</sup> door area).

# High Performance Door RapidRoll® 660



## ADVANTAGES OF ALBANY RAPIDROLL® 660

- extremely robust, tear-resistant RollTex® fabric
- remarkably long life length
- the curtain tension and counterbalance system, that ensures a secure opening and closing movement and permanent curtain tension in all situations
- RollTex® door curtain with 5-year guarantee (see guarantee certificate) fitted as standard

## APPLICATION

- as a room and environment divider to save energy
- as an exterior door for demanding outdoor conditions

## DESIGN

The top roll consists of a steel tube with welded end caps. The shafts are supported on both sides by bearings. The curtain is riveted to the top roll and sealed towards the wall. Anodised aluminium side frames on both sides of the curtain guide its upward and downward movement. Hinges allow to open the side frame for service. A cover of anodised aluminium protects the front of the top roll.

## DOOR CURTAIN

The door curtain is made of extremely rigid, tear-resistant RollTex® fabric. Tensile strength: 185 kN/m. The coated fabric seals against moisture and drafts. Standard colours are blue, orange and grey. A counterbalance is provided by tension springs. The tension spring system also ensures that the door curtain remains firm and taut regardless of high wind loads.

Wind bars are available as an option to improve the wind resistance of the door significantly. The wind bars can be fitted in front, behind or on both sides of the curtain. Additional space requirement depending on their location.

## KNOCK-OUT CAPABILITY

Self repairing knock-out capability - SRD. The door can be fitted with an optional knock-out capability for sizes up to 5.5 x 5.5 m (max. 22 m² door area).

## DRIVE UNIT

3-phase asynchronous motor with worm gear and connector is mounted directly to the top roll. Drive position left- or right-hand side.

## CONTROL SYSTEM

The door is fitted with an ACS 70 type frequency converter control system as standard. An ACS 50 type control system is available as an option.

## MANUAL ACTIVATION

In the event of a power failure, the door curtain can be released and lifted manually with the support of the tension springs in the counterbalance system.

## SAFETY FEATURES

This door is designed according to the regulations of the Workplace Directive of the UVV as well as the harmonized CE Guidelines including the EN 13241-1.

## INDICATION OF RISK

The security of the door is designed for normal use for vehicles in industrial environment corresponding to the harmonized CE-Guidelines. In consideration of the situation on site - especially in case of use by pedestrians - additional safety measures, like additional actuators may be required. Next to this, special environmental conditions may have impact on the right choice of doortype. In case of any doubt please contact our sales engineer for advice in your application.

Technical Data		
<b>Exterior door</b>	suitable	
<b>Interior door</b>	suitable	
<b>Wind resistance</b>	class 2 - EN 12424	
<b>Door dimension (mm)</b>	For details please note general drawing!	
DW max.	6500 mm	
DH min. / max.	2300 / 8000 mm	
Door area max.	32 m²	
<b>Opening direction</b>	vertical	
<b>Surface</b>		
Side frames	anodised aluminium	
Top roll	Steel tube	
Bottom profile	anodised aluminium	
<b>Covers (standard)</b>		
Top roll motor cover	anodised aluminium <sup>1)</sup>	
<b>Door curtain (alternatively)</b>		
RollTex® plus	✓ (max. 22 m²)	
- without window	✓	
- with window	•	
RollTex® Original		
with acrylic coating	✓ (above 22 m²)	
NomaTex®	•	
PVC with alternative coloured reinforcement stripes	• up to 4 x 4,2 m	
<b>Anti-Static brush</b>	•	
<b>Wind bar</b>	•	
<b>Curtain tension</b>	✓	
<b>Counterbalance</b>	✓	
<b>Drive unit</b>	electric / IP 54	
<b>Chain drive</b>	•	
<b>Control systems</b>		
ACS 50	•	
ACS 70	✓	
<b>Safety</b>		
Pneumatic safety contact edge	✓	
Electrical safety contact edge	•	
Pre-running safety photocell	•	
Door line photocell	✓	
Fall down protection	✓ (via tension springs)	
Knock-out capability (SRD)	•	
Manual activation	✓ Bowden lever, operated from the floor	
Second bowden lever	•	
<b>Speed (m/s)</b>	<b>ACS 50</b>	<b>ACS 70</b>
open/close up to max. /m/s	1,7 / 0,85	3,0 / 1,2-1,0
Fuse protection	6,3 A	10/16 A
Control voltage	24 V DC	24 V DC
Protection degree	IP 65	IP 65
<b>Motor power / kW</b>		
up to DW = 6000 mm	0,55 – 1,1 kW	1,1 kW
over DW = 6000 mm	1,1 kW	1,5 kW
L/N/PE 200/230/240V;50/60Hz	✓	
2L/PE 400/440/500V;50/60 Hz	•	
3L/(N)/PE 230/400/415V;50 Hz	✓	
3L/(N)/PE 200/440/500V; 50 Hz	•	
Additional opening heights	• ✓	
Potential free contacts max. 250 V	✓ •	
<b>Traffic light function</b>		
without direction detection	• •	
Flashing alarm light	• • (230 V)	
Error message	✓LED's ✓encoded	
• Optional ✓Standard		
1) For doors of height ≤ 2500 mm the use of top roll and motor cover is required according to the standard EN 13241-1.		

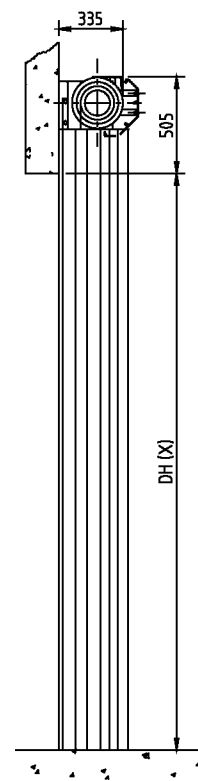
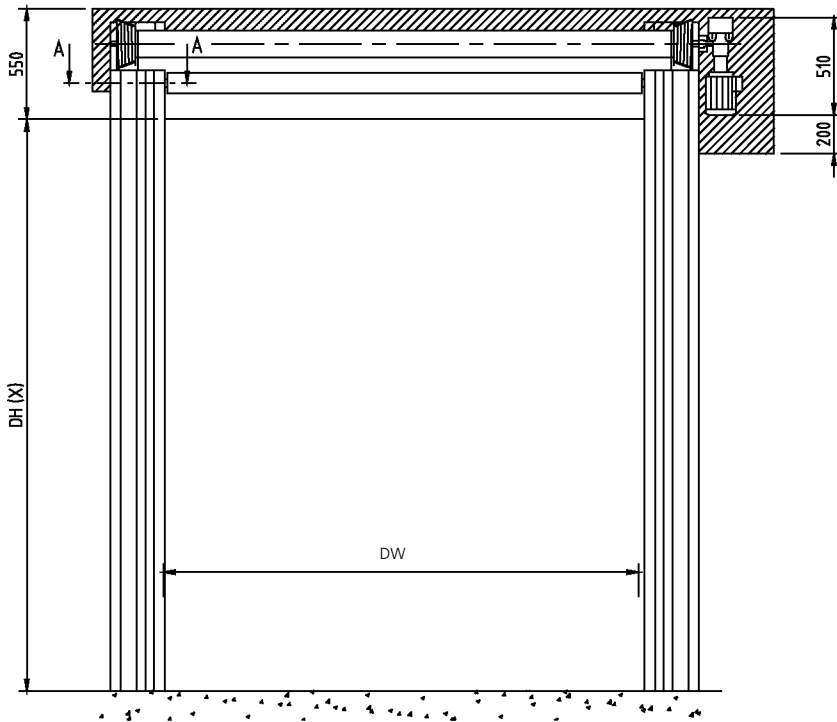

With fascia.

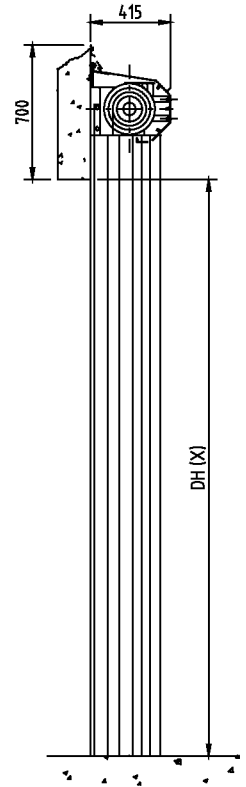

With fascia and hood.

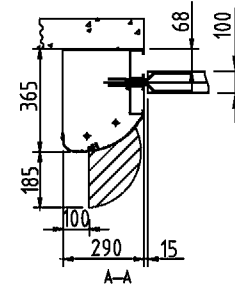
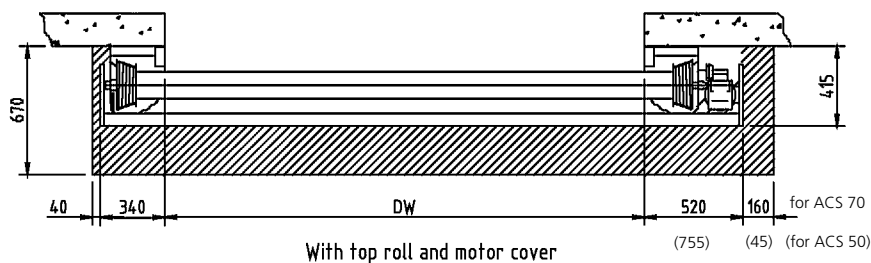
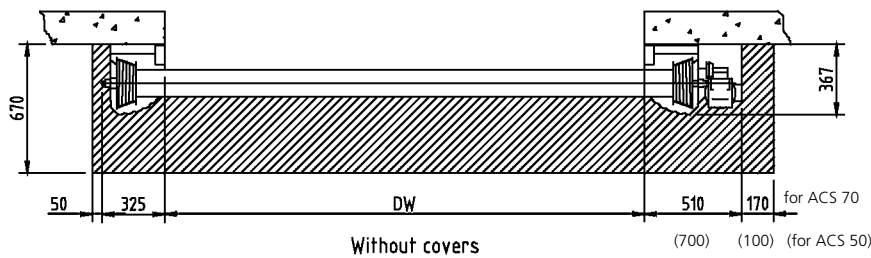

Shaded areas indicate the space that is needed for installatin and servicing. If the required space is not available, please consult Albany Door Systems.

X = Add 100 mm to DH for each windbar on one side.

**Important for crash system:**

The opening width shall be 20 mm wider than the door width.

Check that the walls are satisfactory for installing the door.  
Use securely-anchored mounting plates.

**Drawing-No.:**

66-118 776-02 (ACS 70)  
66-121645-05 (ACS 50)

**Date:**

2004-08-18 (ACS 70)  
2005-02-16 (ACS 50)

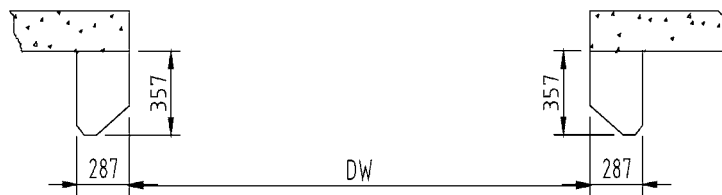
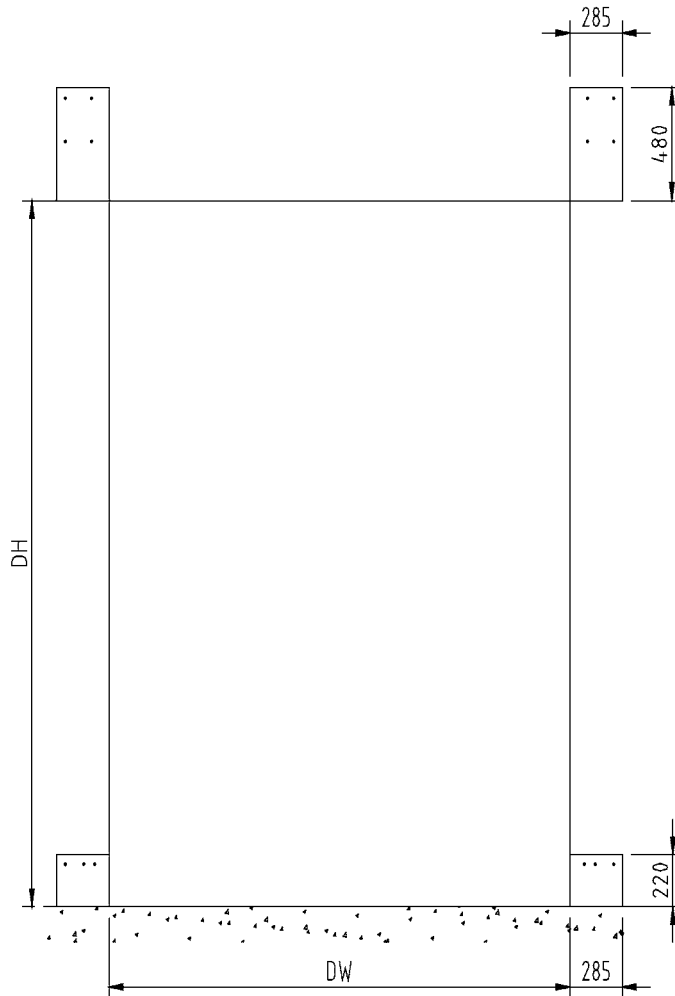

**Drawing-No.:** 66-118 777-02  
**Date:** 2004-08-18

## ALBANY DOOR SYSTEMS

### ASIA

KIARA PARK 174-1-7 • JLN. BURHANUDDIN HELMI  
TTDI, 60.000 KUALA LUMPUR  
PHONE: +60 (0) 3 77 27 01 84 • FAX: +60 (0) 3 77 27 01 84  
INFO.ADS.MY@ALBINT.COM

### AUSTRALIA

23 FAUNCE ST. WEST GOSFORD • 2250 NSW  
PHONE: +61 (0) 2 / 43 23 23 86 • FAX: +61 (0) 2 / 43 29 11 45  
SALES.ADS.AU@ALBINT.COM

### GERMANY

AM MONDSCHEN 25 • 59557 LIPPSTADT  
PHONE: +49 (0) 29 41 / 766-0 • FAX +49 (0) 2941 / 766-294  
VERKAUF.ADS.DE@ALBINT.COM

### SWEDEN

BOX 509 • S - 301 80 HALMSTAD  
PHONE: +46 (0) 35/14 73 00 FAX: +46 (0) 35/14 73 99  
SALES.ADS.SE@ALBINT.COM

### USA

975-A OLD NORCROSS ROAD • LAWRENCEVILLE • GA 30045-4321  
PHONE: +1 (0) 7 770 / 338 / 5000 • FAX: +1 (0) 770/338/5024  
SALES.ADS.US@ALBINT.COM

In most countries our doors are available through subsidiaries or representatives, see

[WWW.ALBANYDOORS.COM](http://WWW.ALBANYDOORS.COM)